

BUILDING DEPARTMENT NOTES:
THIS PLAN IS APPROVED ONLY FOR WORK INDICATED ON THE APPLICATION SPECIFICATION SHEET. ALL OTHER MATTERS SHOWN ARE NOT TO BE RELIED UPON, OR TO BE CONSIDERED AS EITHER BEING APPROVED OR IN ACCORDANCE WITH APPLICABLE CODES.

Project Number:
P1-3601
NYC Development Hub

Project Name:
P-138.03

Project Address:
501 WEST 30TH STREET

Project City:
NEW YORK, NY

Project State:
NEW YORK

Project Zip:
10013

Project Date:
12-07-2012

Project No.:
14752-A.000

Sheet No.:
39

HUDSON YARDS - TOWER C

501 WEST 30TH STREET
NEW YORK, NY



Client
Related Companies
60 Columbus Circle
New York, NY 10023
Tel: 212.801.1000 Fax: 212.801.1048

Oxford Properties Group
320 Park Avenue, 17th Floor
New York, NY 10022
Tel: 212.986.7514 Fax: 212.986.7510

Construction Manager
Fishman Construction Corporation
100 Park Avenue, 5th Floor
New York, NY 10017
Tel: 212.708.5600

Architect
Kohn Pedersen Fox Associates PC
Architects & Planning Consultants
11 West 42nd Street
New York, NY 10036
Tel: 212.977.6500 Fax: 212.956.2526

Structural Engineer
Thornton Tomasetti, Inc.
51 Madison Avenue
New York, NY 10010
Tel: 917.661.7800 Fax: 917.661.7801

Mechanical, Electrical, Plumbing, Fire Protection
Jaros Baum & Bolles Consulting Engineers
80 Pine Street
New York, NY 10013
Tel: 212.530.9300 Fax: 212.269.5894

3	ISSUED FOR FILING	06-29-2015
8	ASL-0216	06-09-2015
7	ISSUED FOR FILING	06-23-2014
6	DI-45 PLUMBING	03-14-2014
5	ASL-0148	03-07-2014
4	DI-40 PLUMBING 100% CD	04-30-2013
3	DI-27 PLUMBING	02-11-2013
2	DI-10 PLUMBING	12-07-2012
1	ISSUED FOR FILING	08-20-2012

Key Plan

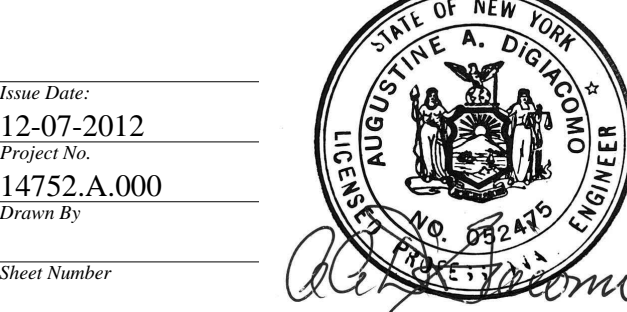
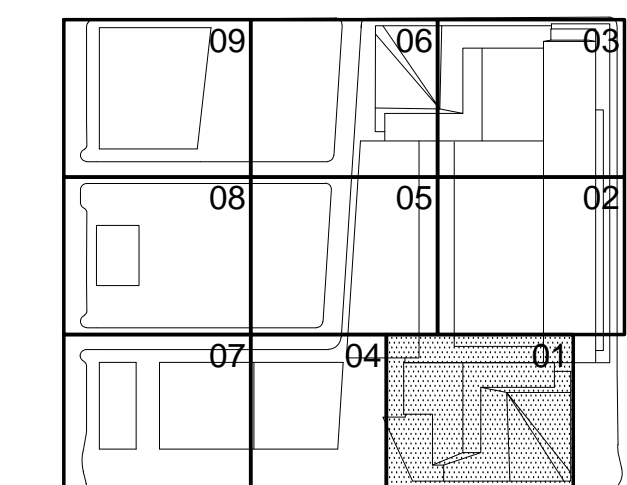

HYE-TC-P1-3601

PLUMBING PLAN 36
[DISPLAY 41]
SECTOR 01

Project Number:
P1-3601
NYC Development Hub

Project Name:
P-138.03

Project Address:
501 WEST 30TH STREET

Project City:
NEW YORK, NY

Project State:
NEW YORK

Project Zip:
10013

Project Date:
12-07-2012

Project No.:
14752-A.000

Sheet No.:
39

Sheet Title:
PLUMBING PLAN 36

Sheet Date:
12-07-2012

Sheet No.:
39

Sheet Title:
PLUMBING PLAN 36

Sheet Date:
12-07-2012

Sheet No.:
39

Sheet Title:
PLUMBING PLAN 36

Sheet Date:
12-07-2012

Sheet No.:
39

Sheet Title:
PLUMBING PLAN 36

Sheet Date:
12-07-2012

Sheet No.:
39

Sheet Title:
PLUMBING PLAN 36

Sheet Date:
12-07-2012

Sheet No.:
39

Sheet Title:
PLUMBING PLAN 36

Sheet Date:
12-07-2012

Sheet No.:
39

Sheet Title:
PLUMBING PLAN 36

Sheet Date:
12-07-2012

Sheet No.:
39

Sheet Title:
PLUMBING PLAN 36

Sheet Date:
12-07-2012

Sheet No.:
39

Sheet Title:
PLUMBING PLAN 36

Sheet Date:
12-07-2012

Sheet No.:
39

Sheet Title:
PLUMBING PLAN 36

Sheet Date:
12-07-2012

Sheet No.:
39

Sheet Title:
PLUMBING PLAN 36

Sheet Date:
12-07-2012

Sheet No.:
39

Sheet Title:
PLUMBING PLAN 36

Sheet Date:
12-07-2012

Sheet No.:
39

Sheet Title:
PLUMBING PLAN 36

Sheet Date:
12-07-2012

Sheet No.:
39

Sheet Title:
PLUMBING PLAN 36

Sheet Date:
12-07-2012

Sheet No.:
39

Sheet Title:
PLUMBING PLAN 36

Sheet Date:
12-07-2012

Sheet No.:
39

Sheet Title:
PLUMBING PLAN 36

Sheet Date:
12-07-2012

Sheet No.:
39

Sheet Title:
PLUMBING PLAN 36

Sheet Date:
12-07-2012

Sheet No.:
39

Sheet Title:
PLUMBING PLAN 36

Sheet Date:
12-07-2012

Sheet No.:
39

Sheet Title:
PLUMBING PLAN 36

Sheet Date:
12-07-2012

Sheet No.:
39

Sheet Title:
PLUMBING PLAN 36

Sheet Date:
12-07-2012

Sheet No.:
39

Sheet Title:
PLUMBING PLAN 36

Sheet Date:
12-07-2012

Sheet No.:
39

Sheet Title:
PLUMBING PLAN 36

Sheet Date:
12-07-2012

Sheet No.:
39

Sheet Title:
PLUMBING PLAN 36

Sheet Date:
12-07-2012

Sheet No.:
39

Sheet Title:
PLUMBING PLAN 36

Sheet Date:
12-07-2012

Sheet No.:
39

Sheet Title:
PLUMBING PLAN 36

Sheet Date:
12-07-2012

Sheet No.:
39

Sheet Title:
PLUMBING PLAN 36

Sheet Date:
12-07-2012

Sheet No.:
39

Sheet Title:
PLUMBING PLAN 36

Sheet Date:
12-07-2012

Sheet No.:
39

Sheet Title:
PLUMBING PLAN 36

Sheet Date:
12-07-2012

Sheet No.:
39

Sheet Title:
PLUMBING PLAN 36

Sheet Date:
12-07-2012

Sheet No.:
39

Sheet Title:
PLUMBING PLAN 36

Sheet Date:
12-07-2012

Sheet No.:
39

Sheet Title:
PLUMBING PLAN 36

Sheet Date:
12-07-2012

Sheet No.:
39

Sheet Title:
PLUMBING PLAN 36

Sheet Date:
12-07-2012

Sheet No.:
39

Sheet Title:
PLUMBING PLAN 36

Sheet Date:
12-07-2012

Sheet No.:
39

Sheet Title:
PLUMBING PLAN 36

Sheet Date:
12-07-2012

Sheet No.:
39

Sheet Title:
PLUMBING PLAN 36

Sheet Date:
12-07-2012

Sheet No.:
39

Sheet Title:
PLUMBING PLAN 36

Sheet Date:
12-07-2012

Sheet No.:
39

Sheet Title:
PLUMBING PLAN 36

Sheet Date:
12-07-2012

Sheet No.:
39

Sheet Title:
PLUMBING PLAN 36

Sheet Date:
12-07-2012

Sheet No.:
39

Sheet Title:
PLUMBING PLAN 36

Sheet Date:
12-07-2012

Sheet No.:
39

Sheet Title:
PLUMBING PLAN 36

Sheet Date:
12-07-2012

Sheet No.:
39

Sheet Title:
PLUMBING PLAN 36

Sheet Date:
12-07-2012

Sheet No.:
39

Sheet Title:
PLUMBING PLAN 36

Sheet Date:
12-07-2012

Sheet No.:
39

Sheet Title:
PLUMBING PLAN 36

Sheet Date:
12-07-2012

Sheet No.:
39

Sheet Title:
PLUMBING PLAN 36

Sheet Date:
12-07-2012

Sheet No.:
39

Sheet Title:
PLUMBING PLAN 36

Sheet Date:
12-07-2012

Sheet No.:
39

Sheet Title:
PLUMBING PLAN 36

Sheet Date:
12-07-2012

Sheet No.:
39

Sheet Title:
PLUMBING PLAN 36

Sheet Date:
12-07-2012

Sheet No.:
39

Sheet Title:
PLUMBING PLAN 36

Sheet Date:
12-07-2012

Sheet No.:
39

Sheet Title:
PLUMBING PLAN 36

Sheet Date:
12-07-2012

Sheet No.:
39

Sheet Title:
PLUMBING PLAN 36

Sheet Date:
12-07-2012

Sheet No.:
39

Sheet Title:
PLUMBING PLAN 36

Sheet Date:
12-07-2012

Sheet No.:
39

Sheet Title:
PLUMBING PLAN 36

Sheet Date:
12-07-2012

Sheet No.:
39

Sheet Title:
PLUMBING PLAN 36

Sheet Date:
12-07-2012

Sheet No.:
39

Sheet Title:
PLUMBING PLAN 36

Sheet Date:
12-07-2012

Sheet No.:
39

Sheet Title:
PLUMBING PLAN 36

Sheet Date:
12-07-2012

Sheet No.:
39

Sheet Title:
PLUMBING PLAN 36

Sheet Date:
12-07-2012

Sheet No.:
39

Sheet Title:
PLUMBING PLAN 36

Sheet Date:
12-07-2012

Sheet No.:
39

Sheet Title:
PLUMBING PLAN 36

Sheet Date:
12-07-2012

Sheet No.:
39

Sheet Title:
PLUMBING PLAN 36

Sheet Date:
12-07-2012

Sheet No.:
39

Sheet Title:
PLUMBING PLAN 36

Sheet Date:
12-07-2012

Sheet No.:
39

Sheet Title:
PLUMBING PLAN 36

Sheet Date:
12-07-2012

Sheet No.:
39

Sheet Title:
PLUMBING PLAN 36

Sheet Date:
12-07-2012

Sheet No.:
39

Sheet Title:
PLUMBING PLAN 36

Sheet Date:
12-07-2012

Sheet No.:
39

Sheet Title:
PLUMBING PLAN 36

<



Client
Related Companies
60 Columbus Circle
New York, NY 10023
Tel: 212.801.1000 Fax: 212.801.1048

Oxford Properties Group
320 Park Avenue, 17th Floor
New York, NY 10022
Tel: 212.986.7514 Fax: 212.986.7510

Construction Manager
Tishman Construction Corporation
100 Park Avenue, 5th Floor
New York, NY 10017
Tel: 212.708.5000

Architect
Kohn Pedersen Fox Associates PC
Architects & Planning Consultants
11 West 42nd Street
New York, NY 10036
Tel: 212.977.6500 Fax: 212.956.2526

Structural Engineer
Thornton Tomasetti, Inc.
51 Madison Avenue
New York, NY 10010
Tel: 917.661.7800 Fax: 917.661.7801

Mechanical, Electrical, Plumbing, Fire Protection
Jaros Baum & Bolles Consulting Engineers
80 Pine Street
New York, NY 10013
Tel: 212.530.9300 Fax: 212.269.5894

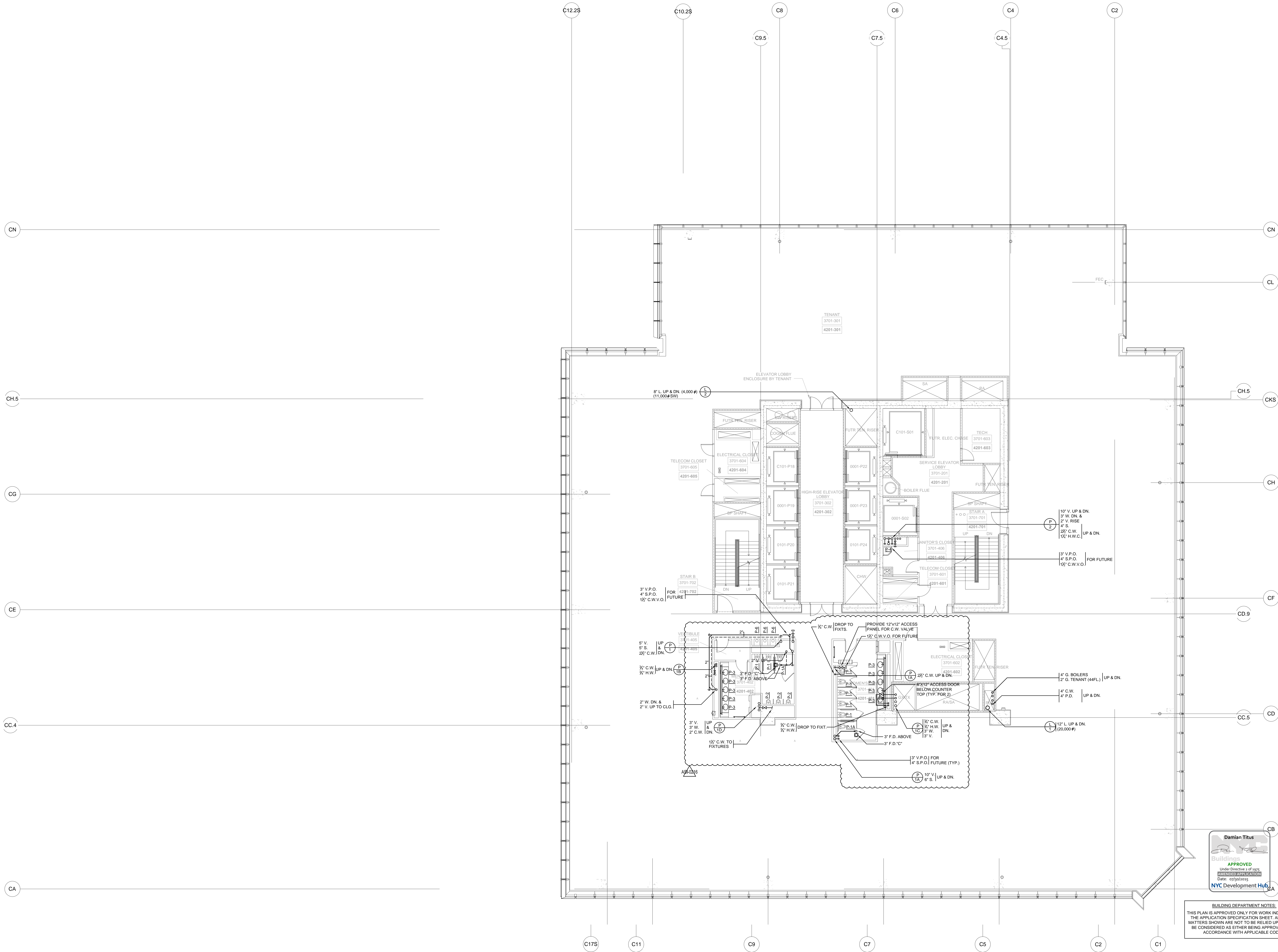

9	ISSUED FOR FILING	06-29-2015
8	ASL-0216	06-09-2015
7	ISSUED FOR FILING	06-23-2014
6	DI-45 PLUMBING	03-14-2014
5	ASL-0148	03-07-2014
4	DI-40 PLUMBING 100% CD	04-30-2013
3	DI-27 PLUMBING	02-11-2013
2	DI-10 PLUMBING	12-07-2012
1	ISSUED FOR FILING	08-20-2012

Key Plan

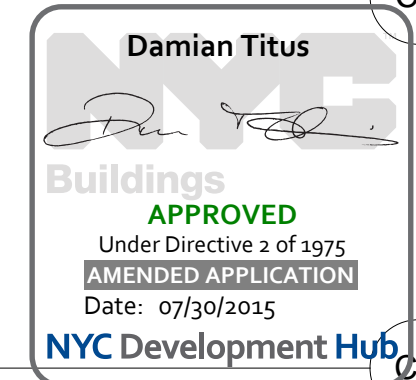
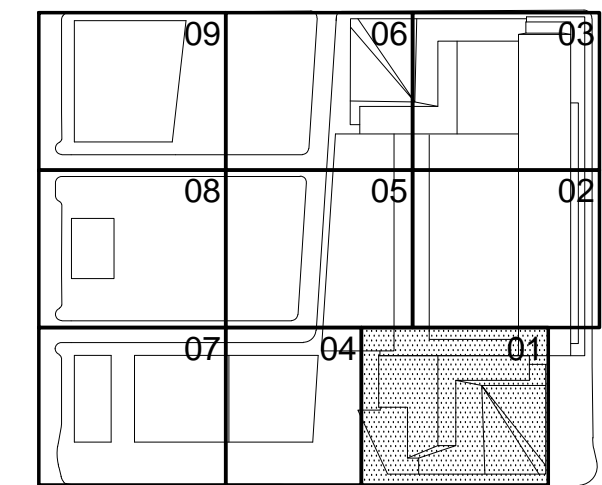

BUILDING DEPARTMENT NOTES:
THIS PLAN IS APPROVED ONLY FOR WORK INDICATED ON THE APPLICATION SPECIFICATION SHEET. ALL OTHER MATTERS SHOWN ARE NOT TO BE RELIED UPON, OR TO BE CONSIDERED AS EITHER BEING APPROVED OR IN ACCORDANCE WITH APPLICABLE CODES.

Drawn By: 12.07.2012
Checked By: 07/30/2015
Project No: 14752-A.000
Sheet No: 01

HYE-TC-P1-3701

PLUMBING PLAN 37
[DISPLAY 42]
SECTOR 01

Drawing Number:
P1-3701
Drawing Title:
P-139.03

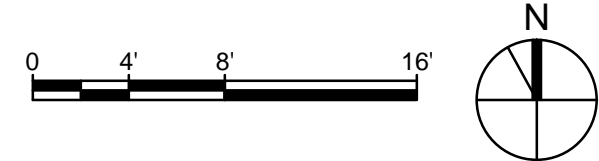

HUDSON YARDS -
TOWER C

501 WEST 30TH STREET
NEW YORK, NY



Client
Related Companies
60 Columbus Circle
New York, NY 10023
Tel: 212.801.1000 Fax: 212.801.1048

Oxford Properties Group
320 Park Avenue, 17th Floor
New York, NY 10022
Tel: 212.986.7514 Fax: 212.986.7510

Construction Manager
Tishman Construction Corporation
100 Park Avenue, 5th Floor
New York, NY 10017
Tel: 212.708.5000

Architect
Kohn Pedersen Fox Associates PC
Architects & Planning Consultants
11 West 42nd Street
New York, NY 10036
Tel: 212.977.6500 Fax: 212.956.2526

Structural Engineer
Thornton Tomasetti, Inc.
51 Madison Avenue
New York, NY 10010
Tel: 917.661.7800 Fax: 917.661.7801

Mechanical, Electrical, Plumbing, Fire Protection
Jaros Baum & Bolles Consulting Engineers
80 Pine Street
New York, NY 10013
Tel: 212.530.9300 Fax: 212.269.5894

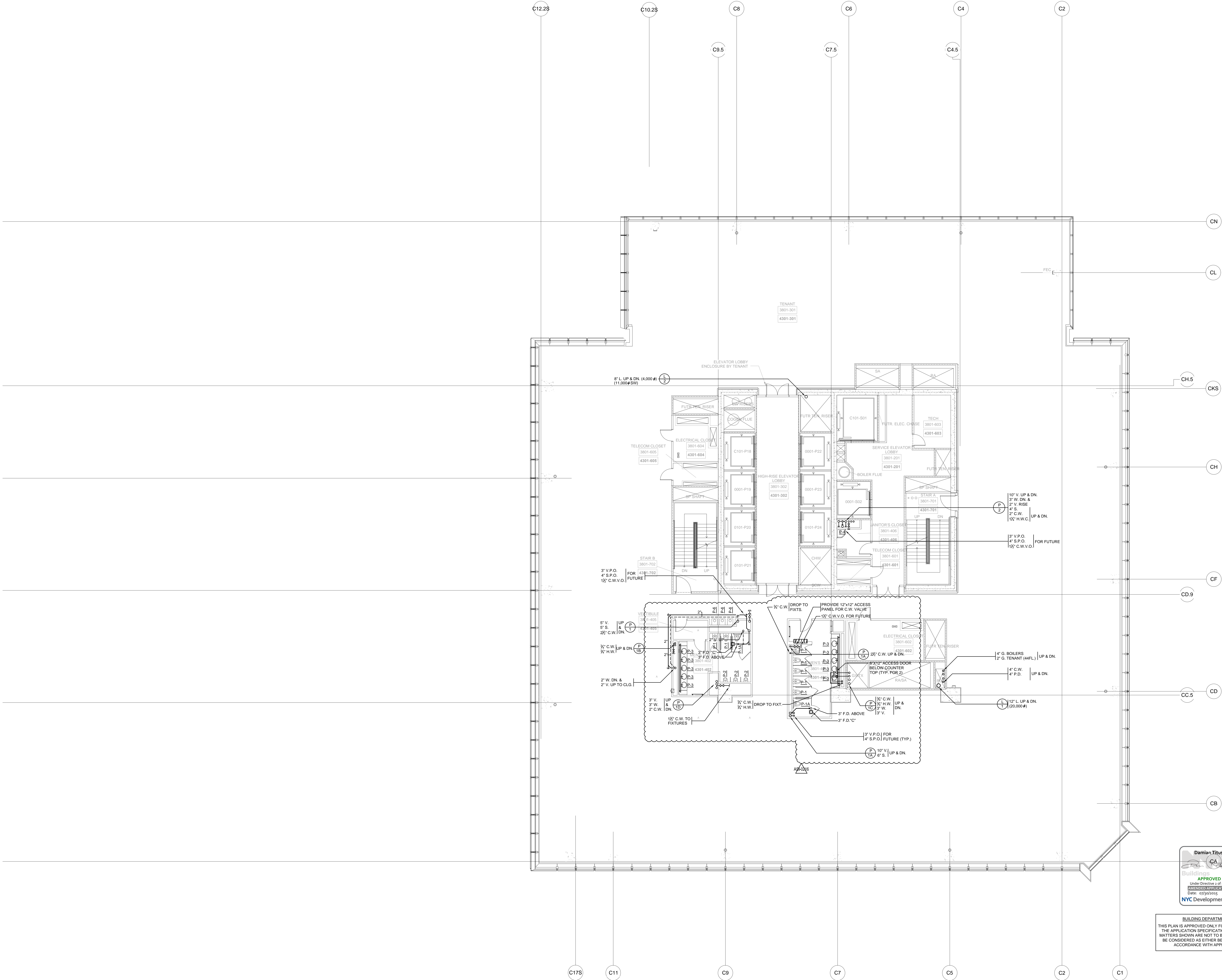

3	ISSUED FOR FILING	06-29-2015
8	ASL-0216	06-09-2015
7	ISSUED FOR FILING	06-23-2014
6	DI-45 PLUMBING	03-14-2014
5	ASL-0148	03-07-2014
4	DI-40 PLUMBING 100% CD	04-30-2013
3	DI-27 PLUMBING	02-11-2013
2	DI-10 PLUMBING	12-07-2012
1	ISSUED FOR FILING	08-20-2012

Key Plan

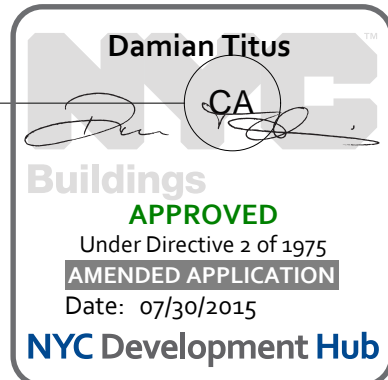
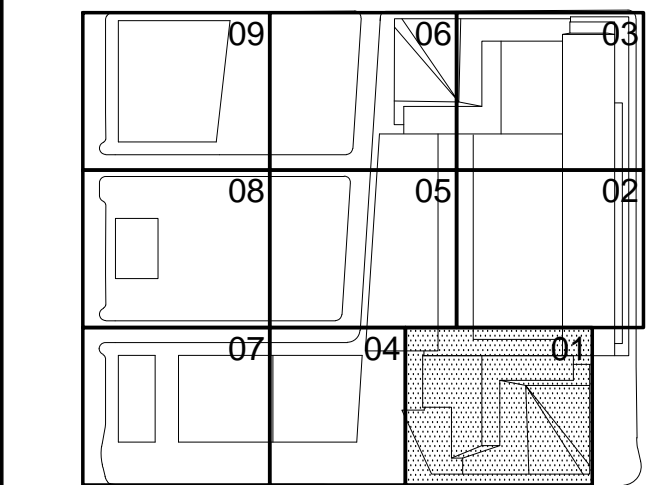

BUILDING DEPARTMENT NOTES:
THIS PLAN IS APPROVED ONLY FOR WORK INDICATED ON THE APPLICATION SPECIFICATION SHEET. ALL OTHER MATTERS SHOWN ARE NOT TO BE RELIED UPON, OR TO BE CONSIDERED AS EITHER BEING APPROVED OR IN ACCORDANCE WITH APPLICABLE CODES.

Project Name:
14752-A.000
14752-A.000
14752-A.000

Project Number:
HYE-TC-P1-3801

Project Name:
PLUMBING PLAN 38
[DISPLAY 43]
SECTOR 01

Project Number:
P1-3801
P-140.03

HUDSON YARDS -
TOWER C

501 WEST 30TH STREET
NEW YORK, NY



Client
Related Companies
60 Columbus Circle
New York, NY 10023
Tel: 212.801.1000 Fax: 212.801.1048

Oxford Properties Group
320 Park Avenue, 17th Floor
New York, NY 10022
Tel: 212.986.7514 Fax: 212.986.7510

Construction Manager
Tishman Construction Corporation
100 Park Avenue, 5th Floor
New York, NY 10017
Tel: 212.708.5000

Architect
Kohn Pedersen Fox Associates PC
Architects & Planning Consultants
11 West 42nd Street
New York, NY 10036
Tel: 212.977.6500 Fax: 212.956.2526

Structural Engineer
Thornton Tomasetti, Inc.
51 Madison Avenue
New York, NY 10010
Tel: 917.661.7800 Fax: 917.661.7801

Mechanical, Electrical, Plumbing, Fire Protection
Jaros Baum & Bolles Consulting Engineers
80 Pine Street
New York, NY 10013
Tel: 212.530.9300 Fax: 212.269.5894

3	ISSUED FOR FILING	06-29-2015
8	ASI-0216	06-09-2015
7	ISSUED FOR FILING	06-23-2014
6	DI-45 PLUMBING	03-14-2014
5	ASI-0148	03-07-2014
4	DI-40 PLUMBING 100% CD	04-30-2013
3	DI-27 PLUMBING	02-11-2013
2	DI-10 PLUMBING	12-07-2012
1	ISSUED FOR FILING	08-20-2012

Key Plan

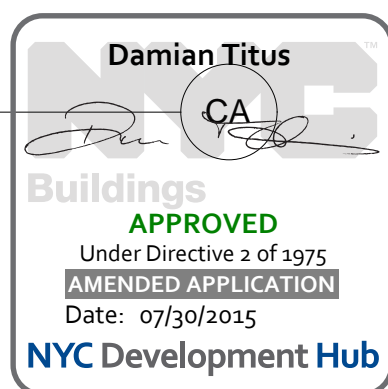
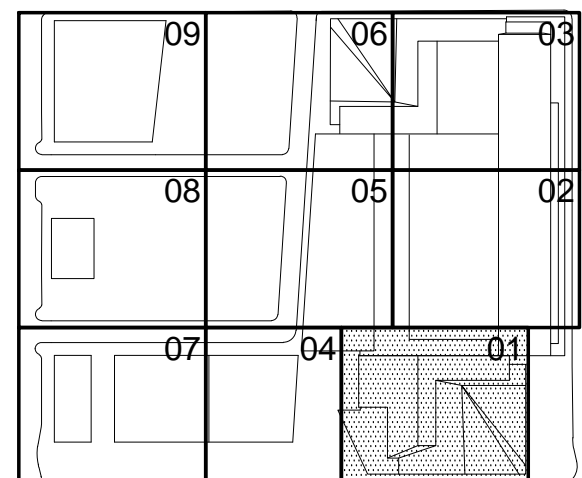

BUILDING DEPARTMENT NOTES:
THIS PLAN IS APPROVED ONLY FOR WORK INDICATED ON THE APPLICATION SPECIFICATION SHEET. ALL OTHER MATTERS SHOWN ARE NOT TO BE RELIED UPON, OR TO BE CONSIDERED AS EITHER BEING APPROVED OR IN ACCORDANCE WITH APPLICABLE CODES.

Project Name:
HYE-TC-P1-3901

Project Name:
PLUMBING PLAN 39
[DISPLAY 44]
SECTOR 01

Project Number:
P1-3901
P-141.03



Client
Related Companies
60 Columbus Circle
New York, NY 10023
Tel: 212.801.1000 Fax: 212.801.1048

Oxford Properties Group
320 Park Avenue, 17th Floor
New York, NY 10022
Tel: 212.986.7514 Fax: 212.986.7510

Construction Manager
Tishman Construction Corporation
100 Park Avenue, 5th Floor
New York, NY 10017
Tel: 212.708.5000

Architect
Kohn Pedersen Fox Associates PC
Architects & Planning Consultants
11 West 42nd Street
New York, NY 10036
Tel: 212.977.6500 Fax: 212.956.2526

Structural Engineer
Thornton Tomasetti, Inc.
51 Madison Avenue
New York, NY 10010
Tel: 917.661.7800 Fax: 917.661.7801

Mechanical, Electrical, Plumbing, Fire Protection
Jaros Baum & Bolles Consulting Engineers
80 Pine Street
New York, NY 10013
Tel: 212.530.9300 Fax: 212.269.5894

9	ISSUED FOR FILING	06-29-2015
8	ASL-0216	06-09-2015
7	ISSUED FOR FILING	06-23-2014
6	DI-45 PLUMBING	03-14-2014
5	ASL-0148	03-07-2014
4	DI-40 PLUMBING 100% CD	04-30-2013
3	DI-27 PLUMBING	02-11-2013
2	DI-10 PLUMBING	12-07-2012
1	ISSUED FOR FILING	08-20-2012

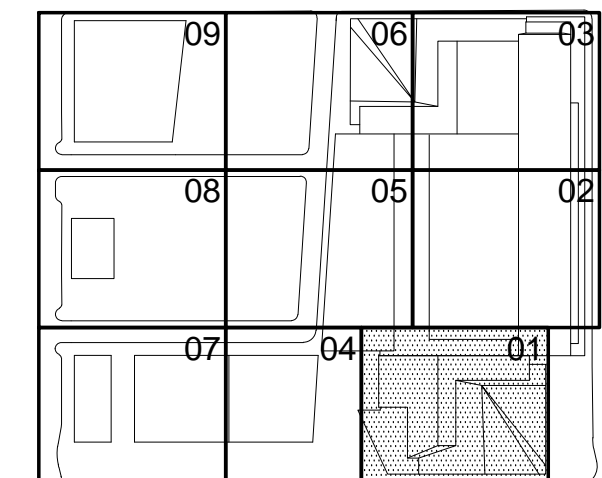

APPROVED
Under Directive 1 of § 205
AMENDED APPLICATION
Date: 07/01/2015
NYC Development Hub

BUILDING DEPARTMENT NOTES:
THIS PLAN IS APPROVED ONLY FOR WORK INDICATED ON THE APPLICATION SPECIFICATION SHEET. ALL OTHER MATTERS SHOWN ARE NOT TO BE RELIED UPON, OR TO BE CONSIDERED AS EITHER BEING APPROVED OR IN ACCORDANCE WITH APPLICABLE CODES.

HYE-TC-P1-4001

PLUMBING PLAN 40
[DISPLAY 45]
SECTOR 01

Project Number:
P1-4001
Drawing Number:
P-142.03

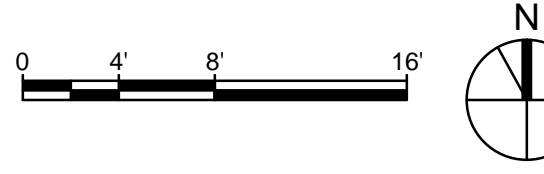
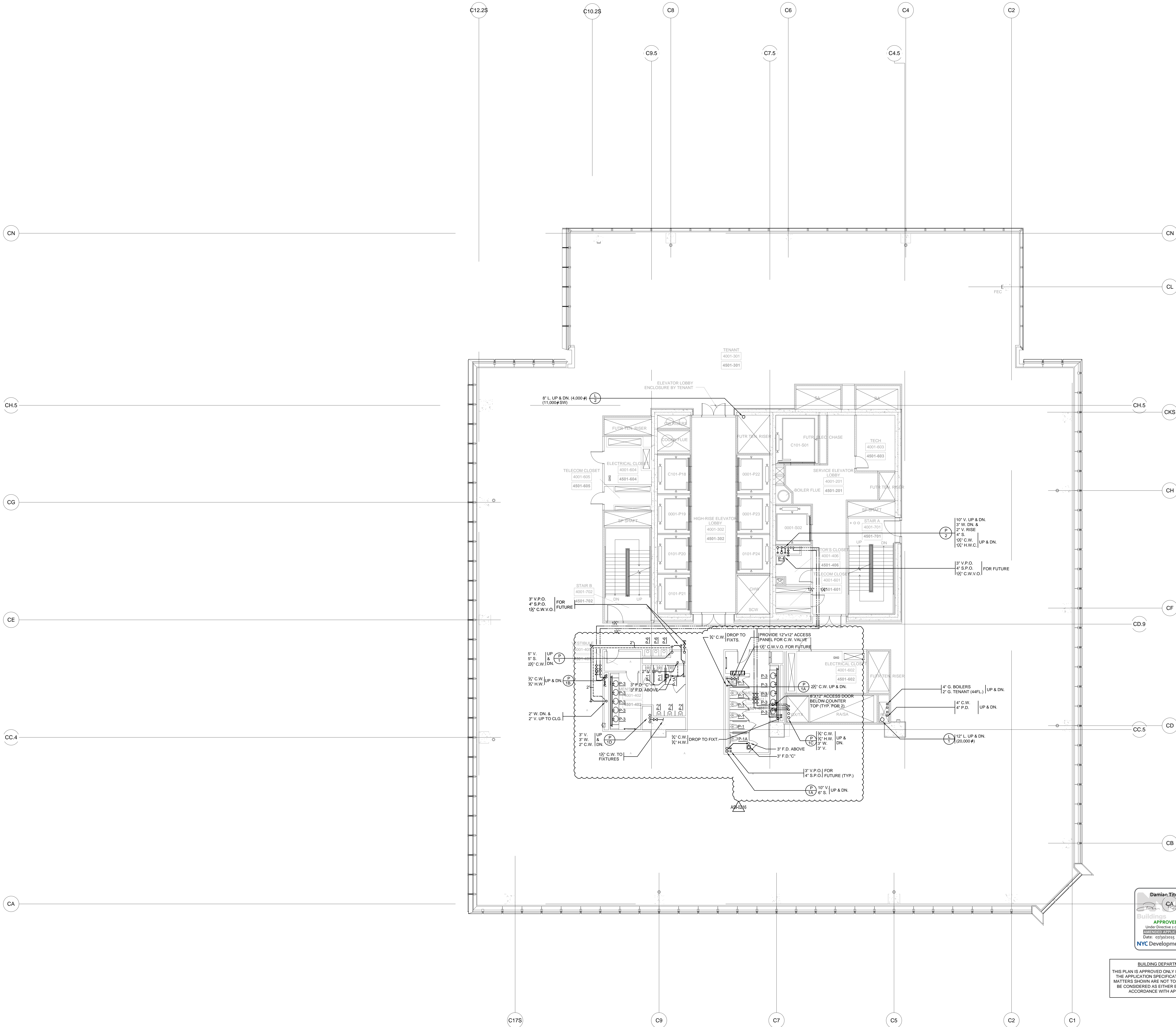



Client
Related Companies
60 Columbus Circle
New York, NY 10023
Tel: 212.801.1000 Fax: 212.801.1048

Oxford Properties Group
320 Park Avenue, 17th Floor
New York, NY 10022
Tel: 212.986.7514 Fax: 212.986.7510

Construction Manager
Tishman Construction Corporation
100 Park Avenue, 5th Floor
New York, NY 10017
Tel: 212.708.5000

Architect
Kohn Pedersen Fox Associates PC
Architects & Planning Consultants
11 West 42nd Street
New York, NY 10036
Tel: 212.977.6500 Fax: 212.956.2526

Structural Engineer
Thornton Tomasetti, Inc.
51 Madison Avenue
New York, NY 10010
Tel: 917.661.7800 Fax: 917.661.7801

Mechanical, Electrical, Plumbing, Fire Protection
Jaros Baum & Bolles Consulting Engineers
80 Pine Street
New York, NY 10013
Tel: 212.530.9300 Fax: 212.269.5894

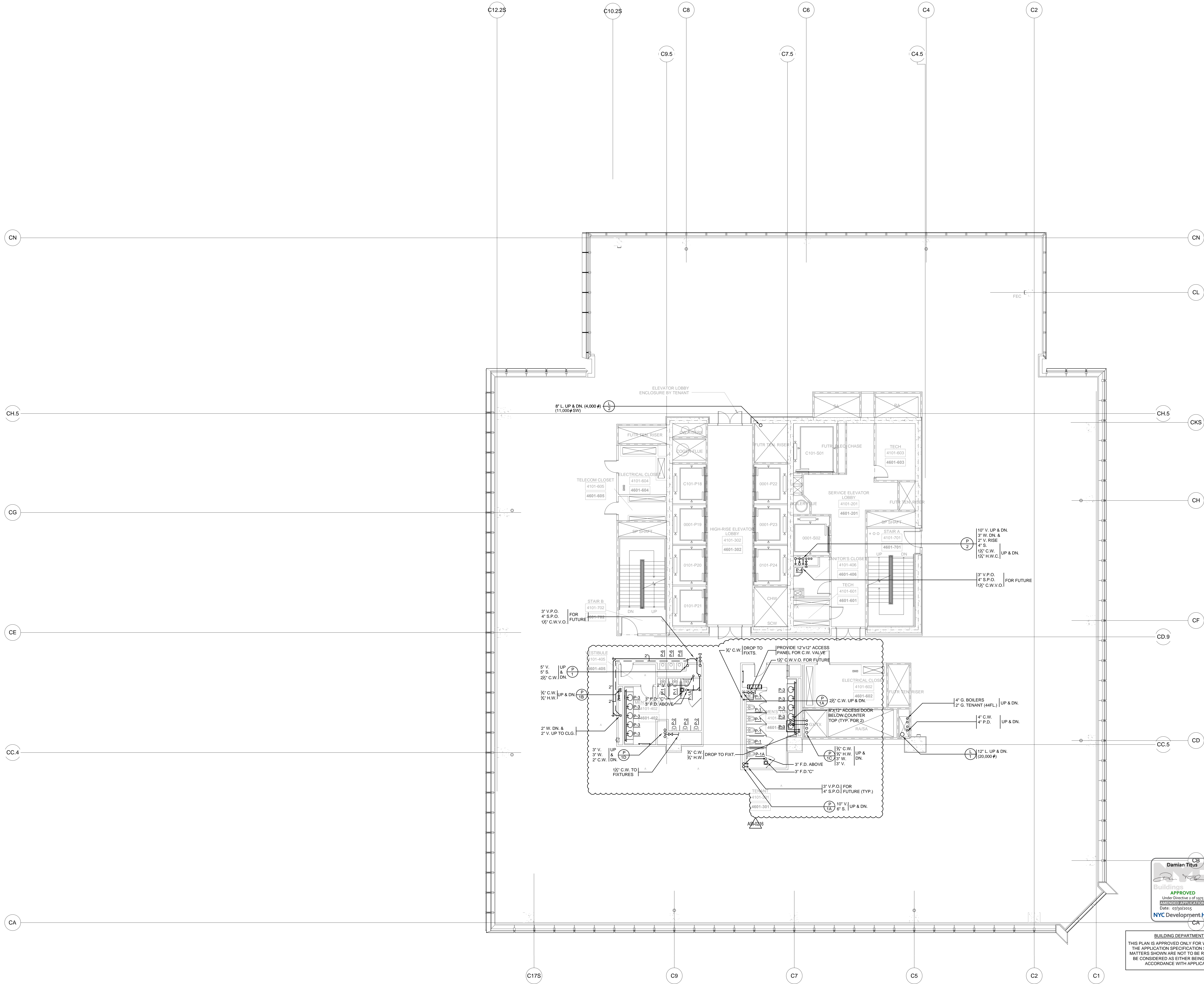

9	ISSUED FOR FILING	06-29-2015
8	ASL-0216	06-09-2015
7	ISSUED FOR FILING	06-23-2014
6	DI-45 PLUMBING	03-14-2014
5	ASL-0148	03-07-2014
4	DI-40 PLUMBING 100% CD	04-30-2013
3	DI-27 PLUMBING	02-11-2013
2	DI-10 PLUMBING	12-07-2012
1	ISSUED FOR FILING	08-20-2012

Key Plan

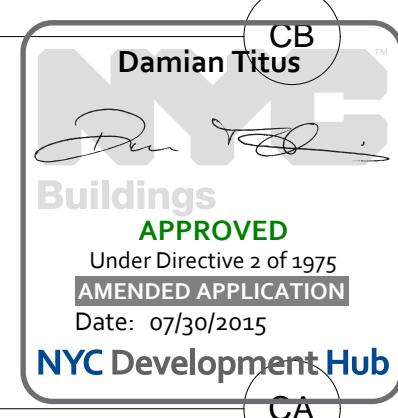
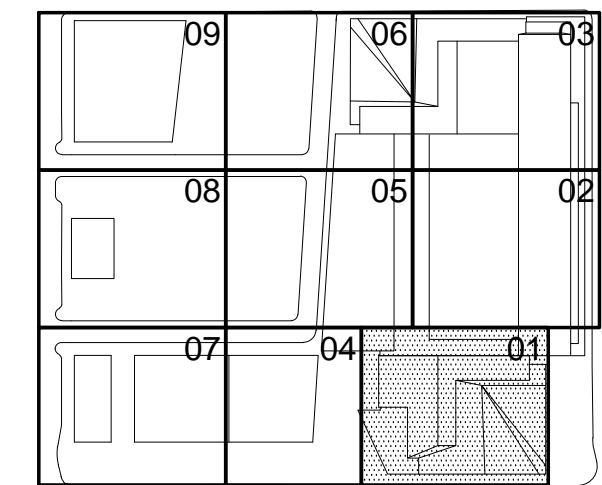

BUILDING DEPARTMENT NOTES:
THIS PLAN IS APPROVED ONLY FOR WORK INDICATED ON
THE APPLICATION SPECIFICATION SHEET. ALL OTHER
MATTERS SHOWN ARE NOT TO BE RELIED UPON, OR TO
BE CONSIDERED AS EITHER BEING APPROVED OR IN
ACCORDANCE WITH APPLICABLE CODES.

Drawn By
12.07.2012
Project No.
14752-A.000
Drawn By

HYE-TC-P1-4101

PLUMBING PLAN 41
[DISPLAY 46]
SECTOR 01

Drawing Number
P1-4101
Drawing Title
P-143.03

HUDSON YARDS -
TOWER C

501 WEST 30TH STREET
NEW YORK, NY



Client
Related Companies
60 Columbus Circle
New York, NY 10023
Tel: 212.801.1000 Fax: 212.801.1048

Oxford Properties Group
320 Park Avenue, 17th Floor
New York, NY 10022
Tel: 212.986.7514 Fax: 212.986.7510

Construction Manager
Tishman Construction Corporation
100 Park Avenue, 5th Floor
New York, NY 10017
Tel: 212.708.5000

Architect
Kohn Pedersen Fox Associates PC
Architects & Planning Consultants
11 West 42nd Street
New York, NY 10036
Tel: 212.977.6500 Fax: 212.956.2526

Structural Engineer
Thornton Tomasetti, Inc.
51 Madison Avenue
New York, NY 10010
Tel: 917.661.7800 Fax: 917.661.7801

Mechanical, Electrical, Plumbing, Fire Protection
Jaros Baum & Bolles Consulting Engineers
80 Pine Street
New York, NY 10013
Tel: 212.530.9300 Fax: 212.269.5894

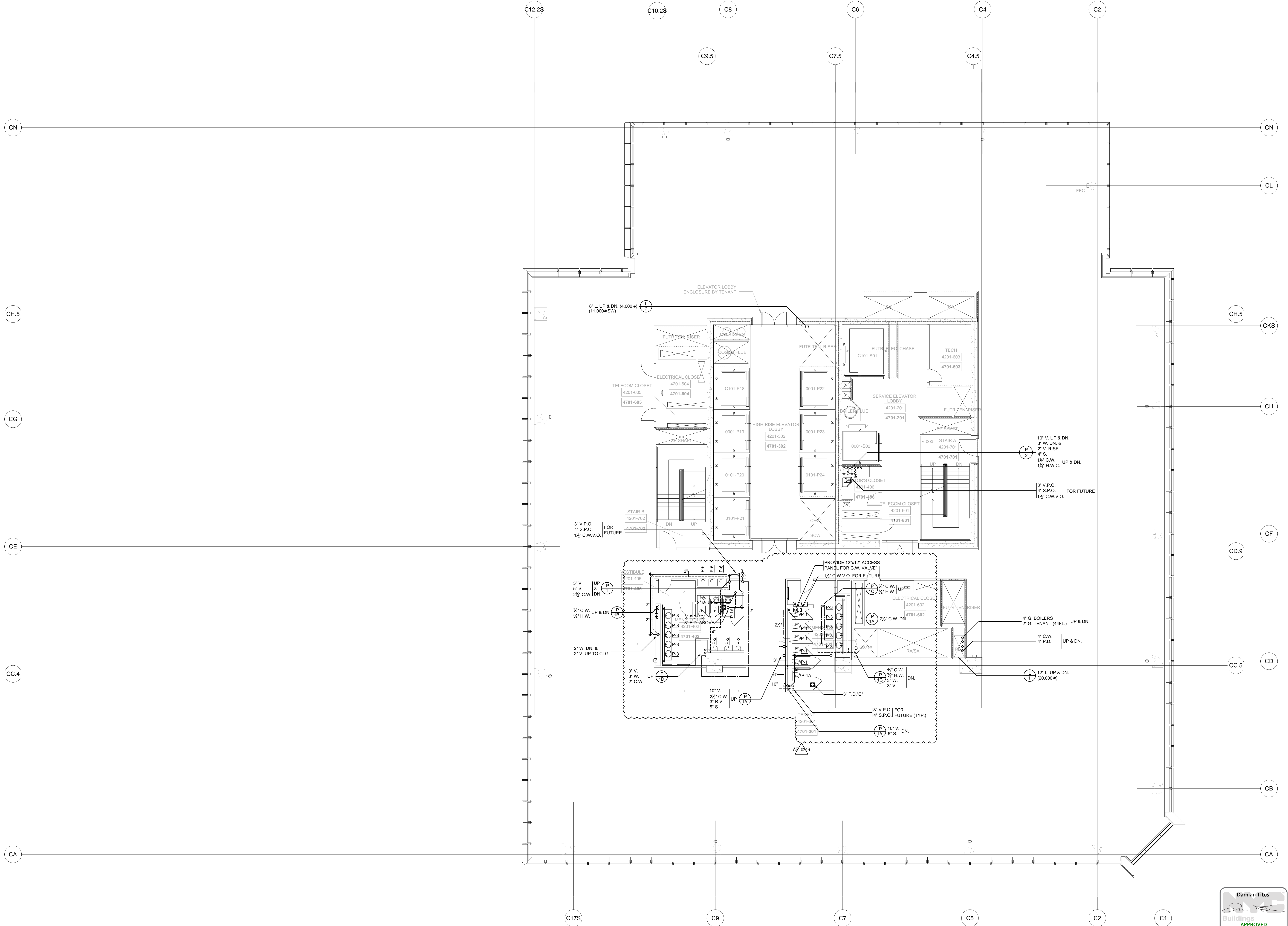

3	ISSUED FOR FILING	06-29-2015
8	ASL-0216	06-09-2015
7	ISSUED FOR FILING	06-23-2014
6	DI-45 PLUMBING	03-14-2014
5	ASL-0148	03-07-2014
4	DI-40 PLUMBING 100% CD	04-30-2013
3	DI-27 PLUMBING	02-11-2013
2	DI-10 PLUMBING	12-07-2012
1	ISSUED FOR FILING	08-20-2012

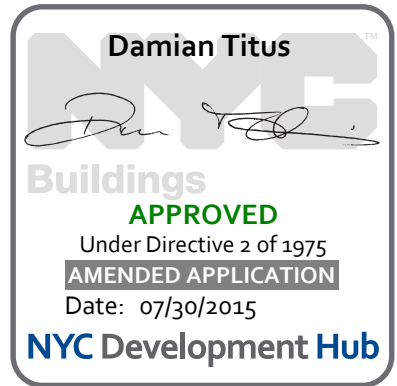
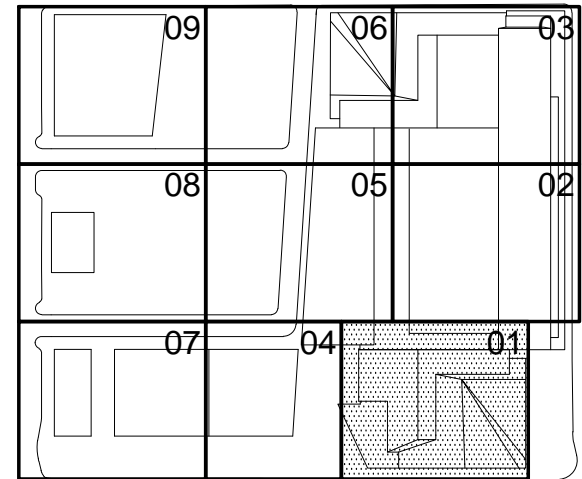

BUILDING DEPARTMENT NOTES:
THIS PLAN IS APPROVED ONLY FOR WORK INDICATED ON THE APPLICATION SPECIFICATION SHEET. ALL OTHER MATTERS SHOWN ARE NOT TO BE RELIED UPON, OR TO BE CONSIDERED AS EITHER BEING APPROVED OR IN ACCORDANCE WITH APPLICABLE CODES.

Project Name:
HYE-TC-P1-4201

**PLUMBING
PLAN 42
[DISPLAY 47]
SECTOR 01**

P1-4201
P-144.03

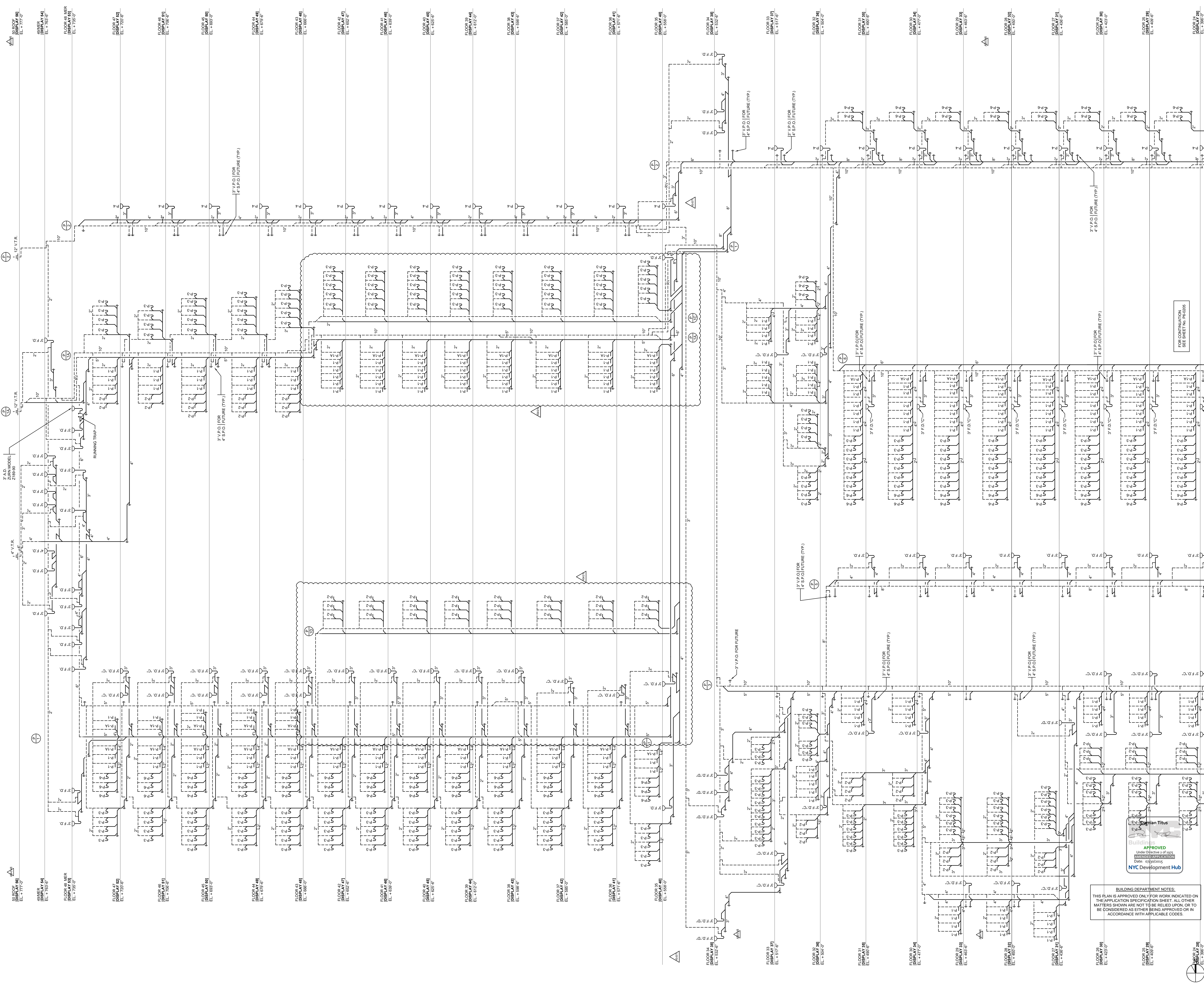

BUILDING DEPARTMENT NOTES:
THIS PLAN IS APPROVED ONLY FOR WORK INDICATED ON THE APPLICATION SPECIFICATION SHEET. ALL OTHER MATTERS SHOWN ARE NOT TO BE RELIED UPON OR TO BE CONSIDERED AS EITHER BEING APPROVED OR IN ACCORDANCE WITH APPLICABLE CODES.

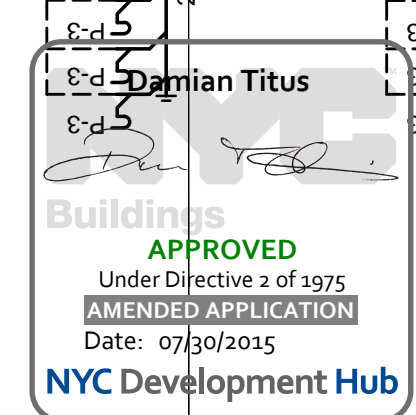

11	ISSUED FOR FILING	06-29-2015
10	ASI-0216	06-09-2015
9	ISSUED FOR FILING	06-23-2014
8	DI-45 PLUMBING	03-14-2014
7	ASI-0148	03-07-2014
6	ASI-0071	09-30-2013
5	DI-40 PLUMBING 100% CD	04-30-2013
4	ISSUED FOR FILING	02-12-2013
3	DI-27 PLUMBING	02-11-2013
2	DI-10 PLUMBING	12-07-2012
1	ISSUED FOR FILING	08-20-2012

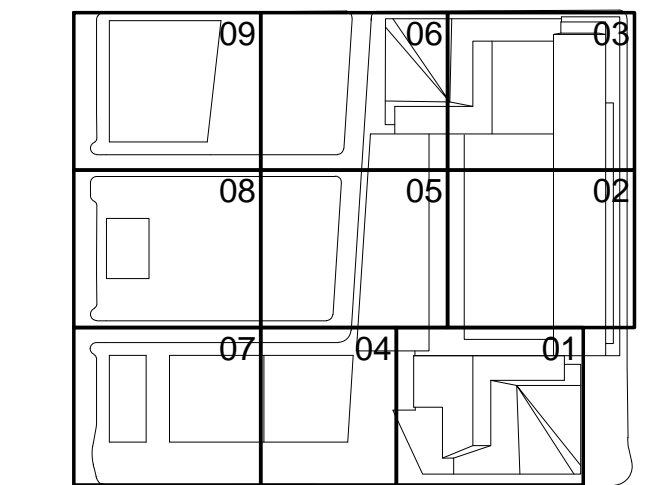

HYE-TC-P6-0205

PLUMBING
HIGH-RISE
SANITARY RISER
DIAGRAM
P6-0205

HYE-TC-P6-0205

Sheet 59 of 68

HUDSON YARDS - TOWER C

501 WEST 30TH STREET
NEW YORK, NY

Client
Related Companies
60 Columbus Circle
New York, NY 10023
Tel: 212.801.1000 Fax: 212.801.1048

Oxford Properties Group
320 Park Avenue, 17th Floor
New York, NY 10022
Tel: 212.986.7514 Fax: 212.986.7510

Construction Manager
Fishman Construction Corporation
100 Park Avenue, 5th Floor
New York, NY 10017
Tel: 212.977.6500 Fax: 212.956.2526

Architect
Kohn Pedersen Fox Associates PC
Architects & Planning Consultants
1 West 42nd Street
New York, NY 10036
Tel: 212.977.6500 Fax: 212.956.2526

Structural Engineer
Thornton Tomasetti, Inc.
51 Madison Avenue
New York, NY 10010
Tel: 917.661.7800 Fax: 917.661.7801

Mechanical, Electrical, Plumbing, Fire Protection
Jaro Baum & Bolles Consulting Engineers
80 Pine Street
New York, NY 10013
Tel: 212.530.9300 Fax: 212.269.5894